

For gold nugget prospecting in mineralised gold field locations.

**GOLD\***

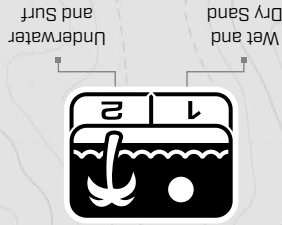

For all salty conditions — dry sand, wet sand, surf and underwater.

**BEACH**

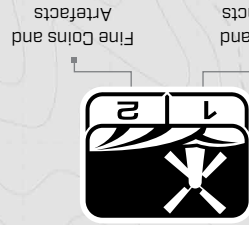

Ideal for detecting in historical fields for the widest range of target sizes.

**FIELD**

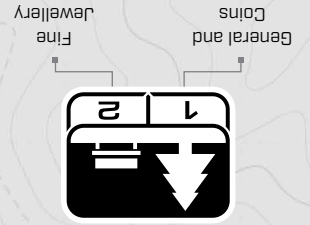

Great for high-trash recreational areas, including most general detecting.

**PARK**

**SEARCH MODES** \*EQUINOX 900 Only



**GO  
DETECTING**



**NOISE  
CANCEL**



**SELECT  
SEARCH MODE**



**TURN  
ON**



**QUICK START**

This Getting Started Guide and the full length EQUINOX® User Manual are available to download online.

Get these languages and more:

- DE Deutsch
- FR français
- KR 한국어
- RU русский
- ES Español
- JP 日本語
- PT Português
- ZH 中文

# EQUINOX

## 700 | 900

**GETTING STARTED GUIDE**



4801-0417-1

## ASSEMBLY

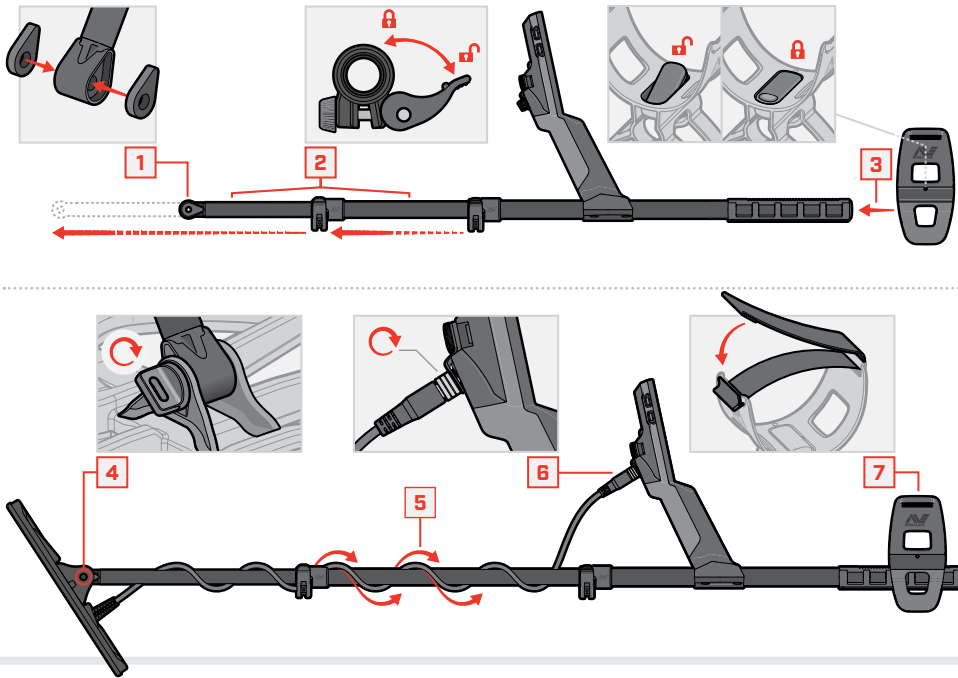

## TIGHTEN CAMLOCKS

Tighten the Camlocks if they slip or become loose.



Open



Tighten gently in increments



Close

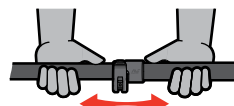

Check and repeat if needed

## CHARGING

5-6 HOURS

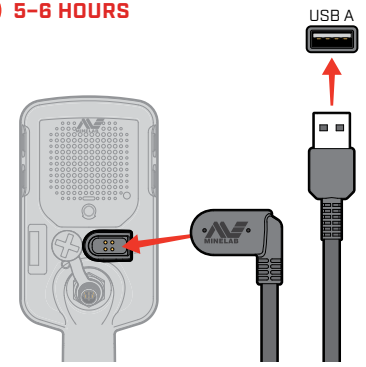

**⚠** Charge your detector with a good-quality USB charger that has a minimum charging capacity of 2A @ 5V.

Risk of USB charger failure if a low quality charger is used.

Look for the following marks on USB chargers:



3 HOURS



## CONTROLS & DISPLAY



\* EQUINOX 900 Only